

Notes:
 This drawing is copyright (C). The reproduction of this drawing is expressly prohibited by Cumming Anderton.
 This drawing may be subject to Local Authority approvals, manufacturer's recommendations and further detailed design.
 Dimensions and conditions shall be verified on site. Any discrepancies between this drawing and site conditions shall be brought to the attention of the architect for resolution prior to placing orders or construction.
 This drawing should not be scaled.
 This drawing is to be read in conjunction with the following drawing Nos.:-

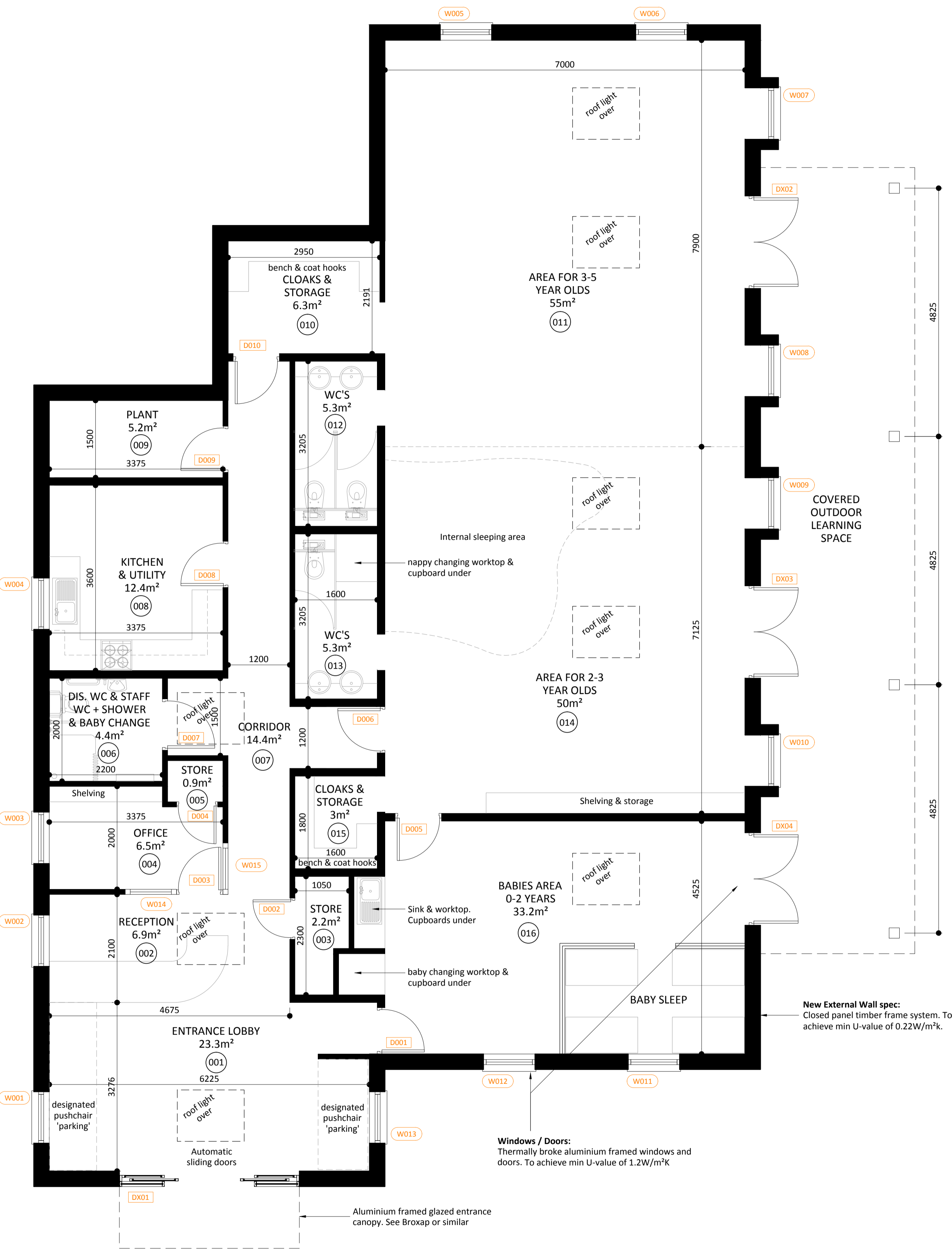

00 GROUND FLOOR PLAN
1:50

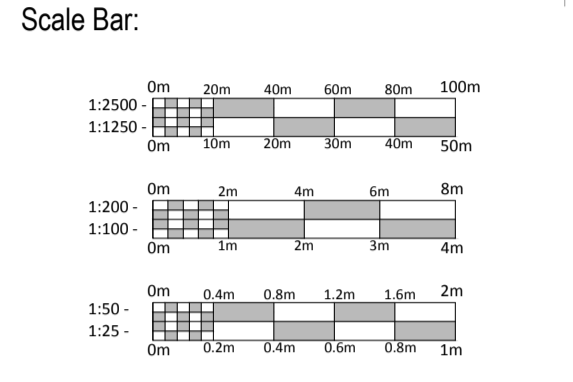
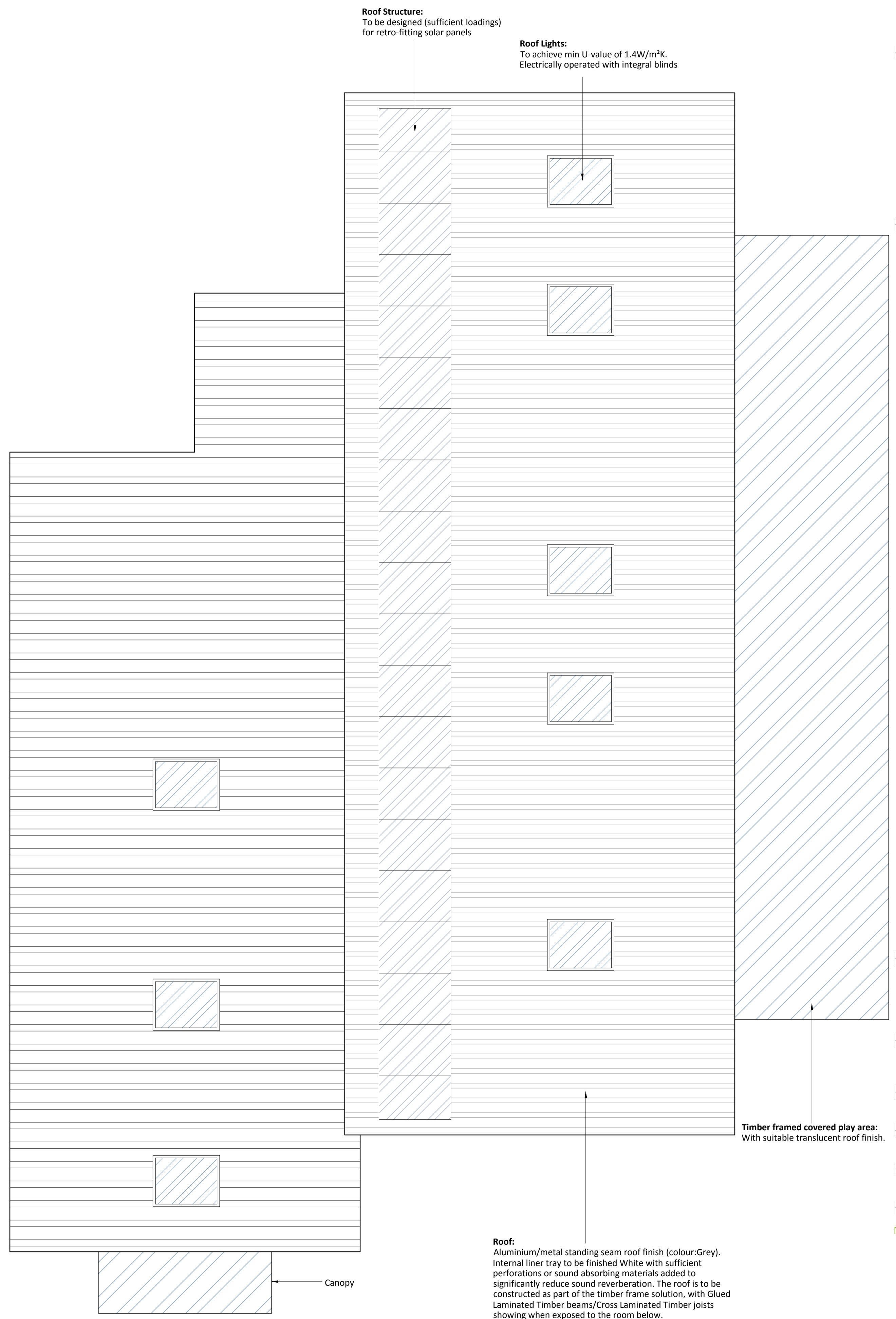

01 ROOF PLAN
1:50

Roof Structure:
To be designed (sufficient loadings) for retro-fitting solar panels

Roof Lights:
To achieve min U-value of 1.4W/m²K. Electrically operated with integral blinds

New External Wall spec:
Closed panel timber frame system. To achieve min U-value of 0.22W/m²K.

Windows / Doors:
Thermally broke aluminium framed windows and doors. To achieve min U-value of 1.2W/m²K

Roof:
Aluminium/metal standing seam roof finish (colour:Grey). Internal liner tray to be finished White with sufficient perforations or sound absorbing materials added to significantly reduce sound reverberation. The roof is to be constructed as part of the timber frame solution, with Glued Laminated Timber beams/Cross Laminated Timber joists showing when exposed to the room below. Roof construction to achieve min U-value of 0.16W/m²K

Timber framed covered play area:
With suitable translucent roof finish.

Rev notes:

Project:
PROPOSED NEW BUILD FOR
DRAYTON PLAYGROUP AT NORTH
OXFORDSHIRE ACADEMY, BANBURY

Drawing:
PROPOSED FLOOR & ROOF PLAN

Scale: 1:50 @ A1	Date: 10.02.14
Job no: 13/920	Drawn by: RW
Drawing no: 100	Revision: -



38 THE GREEN SOUTH BAR
 BANBURY OXON OX16 9AE
 T 01295 272770 F 01295 756365
 E mail@cumminganderton.com
www.cumminganderton.com